

**REPORT TO MAYOR AND COUNCIL****TO THE HONORABLE MAYOR AND COUNCIL:**

DATE: June 22, 2009

**SUBJECT: ADOPT RESOLUTION NO. 09-52 AUTHORIZING ESTABLISHMENT OF PERMIT PARKING ON GILL DRIVE (BETWEEN GRANT STREET AND GILL COURT) AND GILL COURT****Report in Brief**

Residents of Gill Drive and Gill Court in the vicinity of Mt. Diablo High School have requested that permit parking be established on these streets to prohibit on-street parking in this neighborhood during school hours except by resident permit. This request was made to protect the neighborhood from long-term parking by students. Vehicles belonging to residents or guests displaying a valid parking permit would be exempt from this parking prohibition. Exhibit A-1 to the attached resolution shows the boundaries of the proposed permit parking area.

Staff recommends that the City Council adopt Resolution No. 09-52 authorizing the inclusion of Gill Drive (between Grant Street and Gill Court) and Gill Court into the residential permit parking program, by prohibiting parking on these streets from 7:00 a.m. to 4:00 p.m. on school days except by resident permit.

**Background**

Several years ago, the City of Concord initiated a residential permit parking program to address concerns regarding excessive parking activities by non-residents within residential neighborhoods, particularly around the downtown BART station. Since then, areas of concern have shifted to schools, large commercial centers, hospital/medical offices and parks, where demand for parking by non-residents has encroached into adjacent residential neighborhoods.

In 2007, the City implemented a temporary parking plan to discourage Mt. Diablo High School students from parking on Gill Drive and Gill Court by prohibiting parking to non-residents in the neighborhood while allowing residents to park vehicles displaying a dashboard permit obtained from the Police Department. This temporary plan has been successful in reducing long-term parking by students since it was deployed two years ago. As a result, neighborhood residents have recently requested that the plan be made permanent by upgrading it to a permit parking program similar to other neighborhoods within the City.

**Discussion**

Residents of Gill Drive and Gill Court have recently signed a neighborhood petition requesting that permit parking be implemented within the proposed area shown in Exhibit A-1 to the attached resolution. This area comprises a total of 37 residences along both Gill Drive and Gill Court. Twenty-four of these residences (or 65%)

**ADOPT RESOLUTION NO. 09-XX AUTHORIZING ESTABLISHMENT OF PERMIT  
PARKING ON GILL DRIVE (BETWEEN GRANT STREET AND GILL COURT) AND  
GILL COURT**

June 22, 2009

Page 2

provided signatures in support of permit parking, exceeding the 50% minimum requirement to be eligible for permit parking as specified in the Concord Municipal Code.

On June 2, 2009, Public Works and Police Staff held a public meeting with the neighborhood community to discuss parking problems, explain the implementation process of permit parking, and answer questions. Residents who attended the meeting reaffirmed their desire to establish permit parking on Gill Drive and Gill Court as initially reflected in the neighborhood petition.

The Director of Public Works reviewed these findings and determined that Gill Drive (between Grant Street and Gill Court) and Gill Court should be incorporated into the City's residential permit parking program.

**Fiscal Impact**

The cost to replace existing parking signs on Gill Drive and Gill Court with the appropriate signs for permit parking would be funded through Public Works' operating budget for signing and striping. Parking permits would be available to all affected residents in the area, and fees would be collected as appropriate on an annual basis. The fee to obtain a permit sticker is \$9.80 per vehicle per calendar year. Each household may purchase up to four permits annually.

**Public Contact**

Posting of the Council agenda. All residences within the proposed permit parking area were notified in writing.

**Recommendation for Action**

Staff recommends that the City Council adopt Resolution No. 09-52 authorizing the inclusion of Gill Drive (between Grant Street and Gill Court) and Gill Court into the residential permit parking program, by prohibiting parking on these streets from 7:00 a.m. to 4:00 p.m. on school days except by resident permit.

Prepared by: Ray Kuzbari  
Transportation Manager  
[Ray.Kuzbari@ci.concord.ca.us](mailto:Ray.Kuzbari@ci.concord.ca.us)

Reviewed by: Qamar Khan  
Director of Public Works  
[Qamar.Khan@ci.concord.ca.us](mailto:Qamar.Khan@ci.concord.ca.us)



Daniel E. Keen  
City Manager  
[Dan.Keen@ci.concord.ca.us](mailto:Dan.Keen@ci.concord.ca.us)

**BEFORE THE CITY COUNCIL OF THE CITY OF CONCORD  
COUNTY OF CONTRA COSTA, STATE OF CALIFORNIA**

**A Resolution Authorizing Establishment of Permit  
Parking on Gill Drive (between Grant Street and Gill  
Court) and Gill Court**

**Resolution No. 09-52**

**WHEREAS**, Concord Municipal Code, Chapter 106 (Traffic and Vehicles), Article VII (Stopping, Standing, And Parking), Division 6 (Permit Parking Areas) provides for the establishment by resolution of permit parking areas in the City; and

**WHEREAS**, more than 50% of the residences on Gill Drive (between Grant Street and Gill Court) and Gill Court signed a petition in support of establishing permit parking on these streets to protect the neighborhood from long-term parking by students from Mt. Diablo High School; and

**WHEREAS**, the Director of Public Works has reviewed said petition and staff findings and determined that Gill Drive (between Grant Street and Gill Court) and Gill Court should be incorporated into the City’s residential permit parking program.

**NOW, THEREFORE, THE CITY COUNCIL OF THE CITY OF CONCORD DOES  
RESOLVE AS FOLLOWS:**

**Section 1.** There is sufficient justification for the establishment of a permit parking area on both sides of Gill Drive (between Grant Street and Gill Court) and Gill Court to protect the neighborhood from long-term parking by students from Mt. Diablo High School.

**Section 2.** A permit parking area shall be established as shown in Exhibit A-1 to this resolution in accordance with Chapter 106, Article VII, Division 6 (Section 106-441 et seq.) of the Concord Municipal Code.

**Section 3.** On-street parking shall be prohibited within said permit parking area from 7:00 a.m. to 4:00 p.m. on school days except by resident or guest parking permit, or as exempted by Section 106-450 (Exemptions) of the Concord Municipal Code.

**Section 4.** The Director of Public Works is hereby authorized and directed to remove and install the appropriate signs to effectuate this resolution.

**Section 5.** This resolution shall become effective immediately upon its passage and adoption.



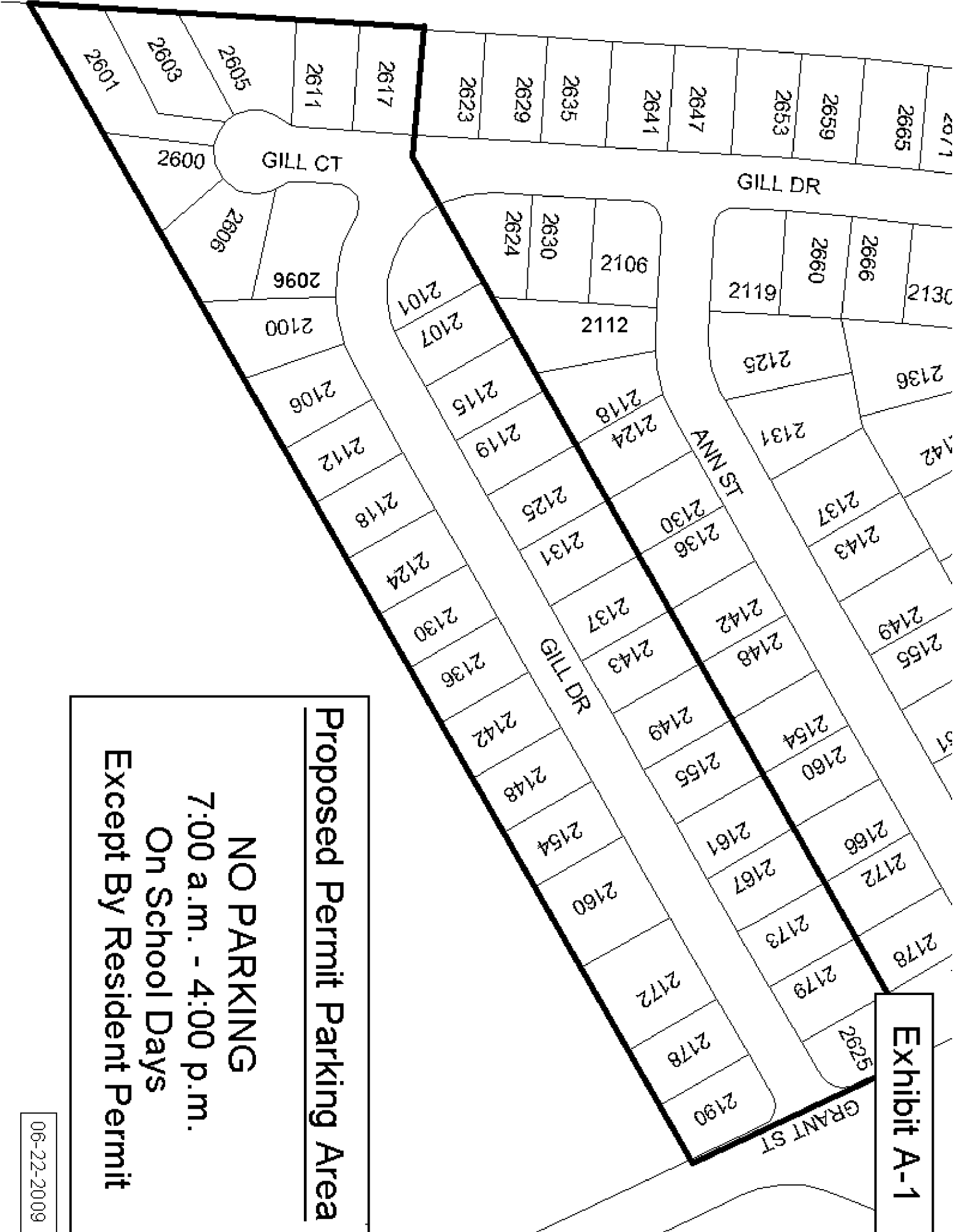

**Exhibit A-1**

**Proposed Permit Parking Area**

**NO PARKING**

**7:00 a.m. - 4:00 p.m.**

**On School Days**

**Except By Resident Permit**

06-22-2009